

## STAINLESS STEEL WAFER TYPE BUTTERFLY VALVE

### SPECIFICATION

FOR BS 4504 PN10 / PN16 FLANGE MOUNTING  
FACE-TO-FACE DIMENSION TO ISO 5752 / BS 5155 / BS EN 593  
LEVER / WORM GEAR OPERATOR

### PRESSURE / TEMPERATURE RATINGS

Working Pressure	16 bar
Testing Pressure	Shell : 24 bar Seat : 17.6 bar
Working Temperature	5°C to 120°C (PTFE Seat) -10°C to 135°C (Viton Seat)
Suitable Media	Water, Oil & Gas

### MATERIALS

Part	Material	BS
Body	Stainless Steel 304	304 C15
	Stainless Steel 316	316 C16
Disc	Ductile Iron	Gr. 420/12
	Aluminum Bronze	1400 AB2
	Stainless Steel 304	304 C15
	Stainless Steel 316	316 C16
Seat Ring	EPDM	
	NBR	
	PTFE	
	Viton	
Shaft	Stainless Steel 410	410 S21
	Stainless Steel 431	431 S29
	Stainless Steel 316	316 S16
Taper Pins	Stainless Steel 316	316 S16
Key	Carbon Steel	
O-Ring	NBR	
Bushing	PTFE	
Lever	Malleable Iron	B35/12
	Stainless Steel	304 S15
Worm Gear	Cast Iron	Gr. 220

### DIMENSIONS

Size mm	A mm	B mm	C mm	D mm	E mm	F mm	G mm	Cv 90°
50	42	80	172	267	254	173	150	135
65	45	89	197	267	289	173	150	220
80	45	100	200	267	294	173	150	302
100	52	114	222	267	297	173	150	600
125	54	127	238	267	329	173	150	1022
150	56	139	248	267	331	173	150	1579
200	61	195	295	358	443	239	285	3136
250	66	203	322	358	475	239	285	5340
300	77	242	367	358	504	226	285	8250
350	77	300	-	-	518	226	285	11917

### SBFV-WB

**PN16**

DN50~350

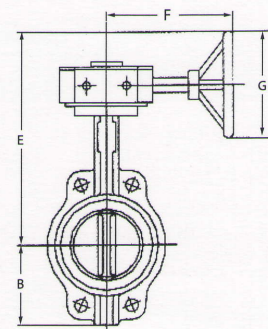
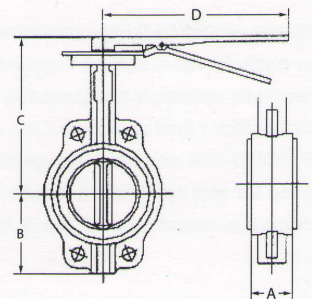
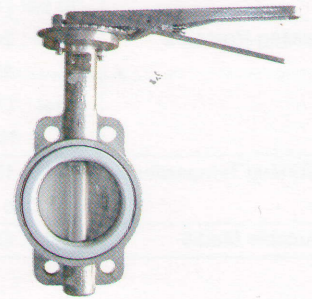

## STAINLESS STEEL WAFER TYPE BUTTERFLY VALVE

### SPECIFICATION

DOUBLE-STAGE WORM GEAR OPERATOR

### PRESSURE / TEMPERATURE RATINGS

Working Pressure	16 bar (400mm ~ 600mm) 10 bar (700mm)
Testing Pressure	Shell : 24 bar (400mm ~ 600mm) 15 bar (700mm) Seat : 17.6 bar (400mm ~ 600mm) 11 bar (700mm)
Working Temperature	5°C to 120°C (PTFE Seat) -10°C to 135°C (Viton Seat)
Suitable Media	Water, Oil & Gas

### DIMENSIONS

Size mm	A mm	B mm	Double-Stage Worm Gear Operator						Cv 90°
			C mm	D mm	E mm	F mm	G mm	H mm	
400	87/102	297	685	104	328	104	279	302	16388
450	106/114	315	707	104	328	104	279	302	21705
500	132	350	758	142	328	145	305	302	27908
600	152	444	849	142	394	145	305	391	43116
700	165	512	1011	173	457	173	358	424	49500

Note:

1. Actuator mounting flange conforms to ISO 5211 drilling.
2. The butterfly valve can be supplied with electric or pneumatic actuator.
3. Pneumatic actuators are available in spring return or double acting.
4. Micro switch / limit switch box are available upon request.
5. JIS B2239 10K and other flange standards available upon request.
6. If used for gas application, please consult our sales office.
7. Design and specifications are subject to change without prior notice.

**SBFV-WB**

**PN16**

DN400~600

**PN10**

DN700

